

■ **3/4 Throttle and check Modular Valves**

■ **Specifications**

Max. Operating Pressure Kgf/cm ²	Max. Flow L/min.
250	500

Graphic Symbols

Model Numbers	Metre-out	Metre-in
MSA-06	 MSA-06-X	 MSA-06-Y
MSB-06	 MSB-06-X	 MSB-06-Y
MSW-06	 MSW-06-X	 MSW-06-Y

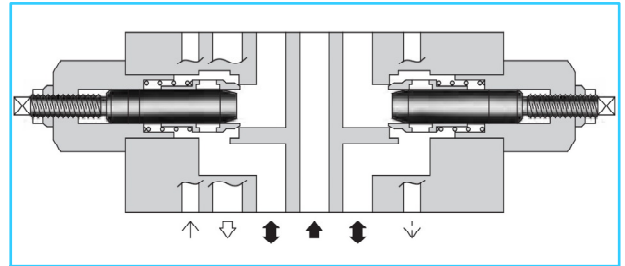

■ **Model Number Designation**

F-	MSA	-06	-X	-30	H01
Special Seals	Series Number	Valve Size	Direction of Flow	Design Number	Design Standard
F: Special Seals for Phosphate Ester Type Fluids (Omit if not required)	MSA: A-Line MSB: B-Line MSW: A & B Line } Throttle and Check Modular Valves	06	X: Metre-Out Y: Metre-In	30	H01

■ **Instructions**

- To **flow adjustment**, loosen the “Lock Nut” then turn the flow adjustment screw clockwise to limit the flow. Be sure to re-tighten the lock nut after the adjustment.

Typical Performance Characteristics

Hydraulic Fluid: Viscosity 35cSt, Specific Gravity 0.850

● **Pressure Drop**

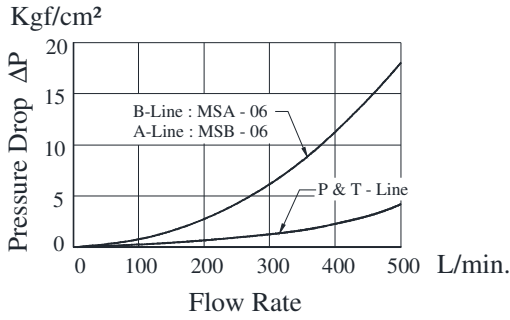

● **Pressure Drop at Throttle Fully Open**

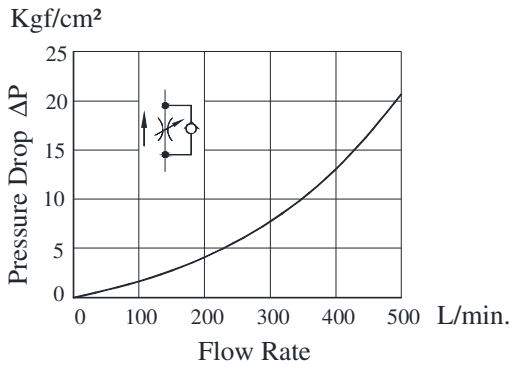

● **Pressure Drop for Free Flow**

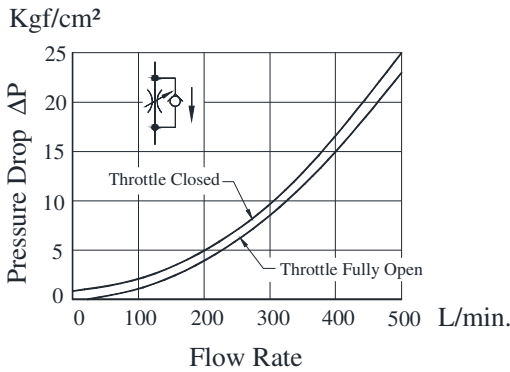

● **Metred Flow vs. Screw Position**

ΔP : Differential Pressure Kg/cm²

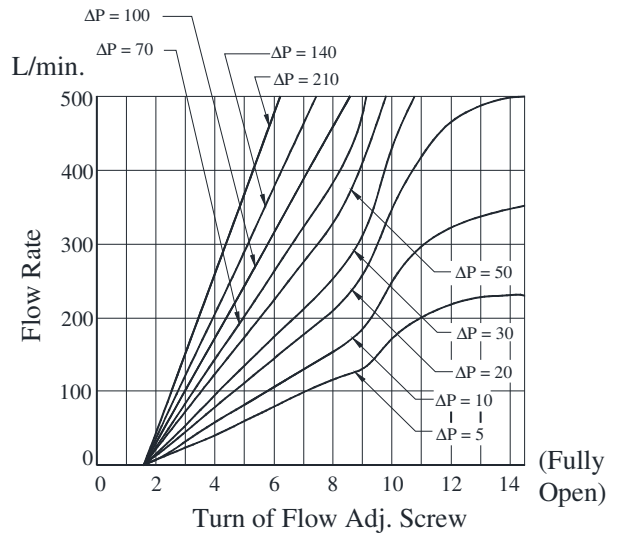

● **MSW-06-X-Y-30H01**

DIMENSIONS IN MILLIMETRES

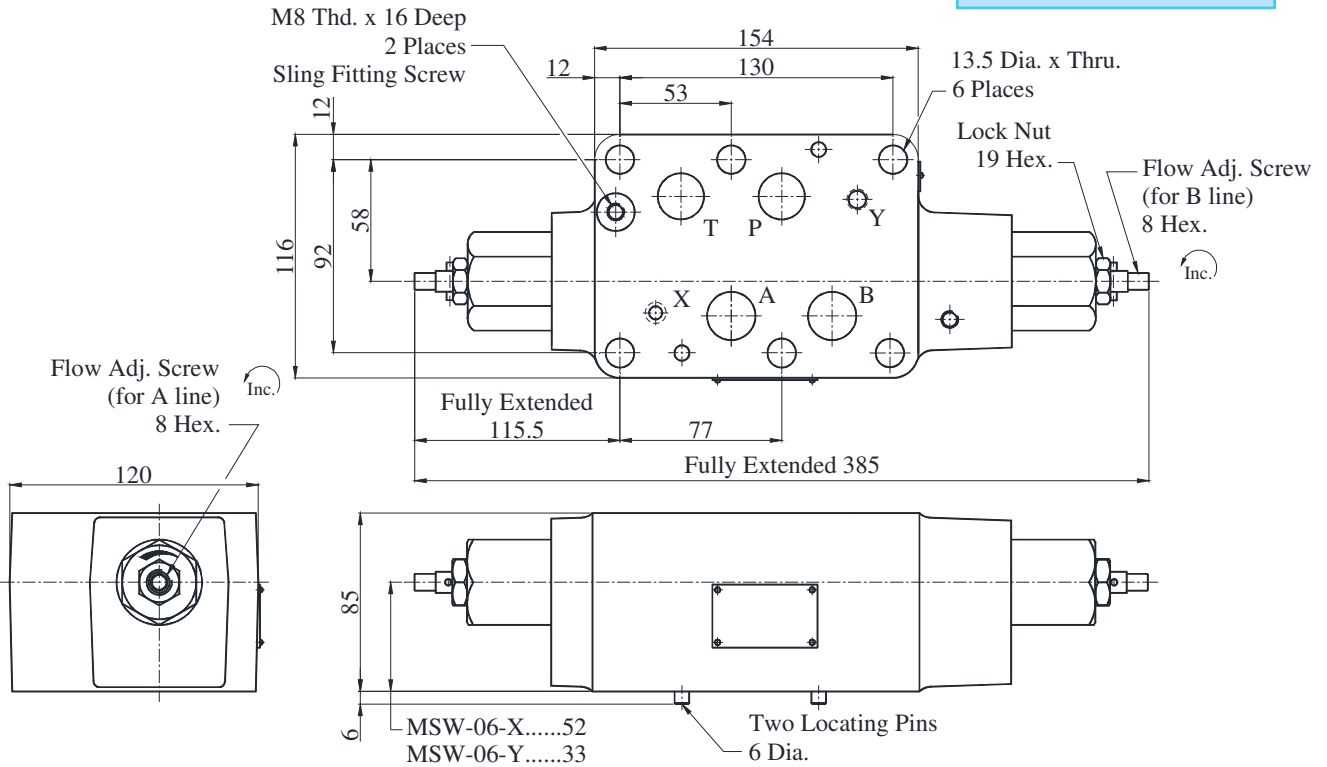

● **MSA-06-X-Y-30H01**

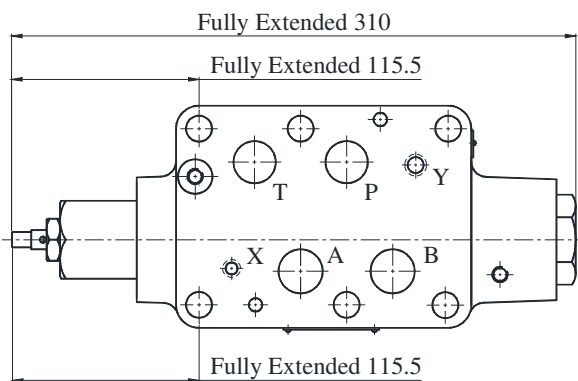

Mass 12Kg(Approx)

For other dimensions, refer to above (MSW-06) drawing.

● **MSB-06-X-Y-30H01**

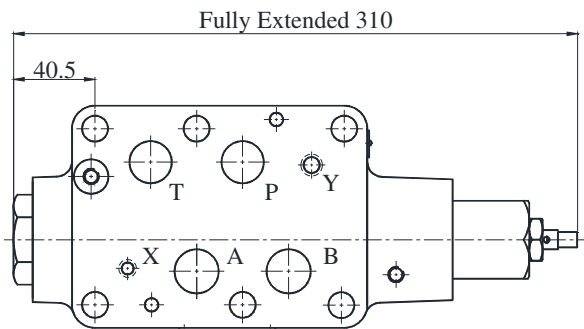

For other dimensions, refer to above (MSW-06) drawing.

Spare Parts List

● **List of Seals**

Sl. No.	Name of Parts	Part Nos.	Quantity		
			MSA-06	MSB-06	MSW-06
1	O-Ring	SO-NA-P14	1	1	2
2	O-Ring	SO-NB-P14	2	2	2
3	O-Ring	SO-NB-P28	4	4	4
4	O-Ring	SO-NB-P32	1	1	2
5	Backup Ring	SO-BB-P14	1	1	2

Note : When ordering the seals, please specify the seal kit numbers from the table below.

● **List of Seal Kits**

Model Nos.	Seal Kit Numbers
MSA-06	KS-MSA-06-30
MSB-06	
MSW-06	KS-MSW-06-30